

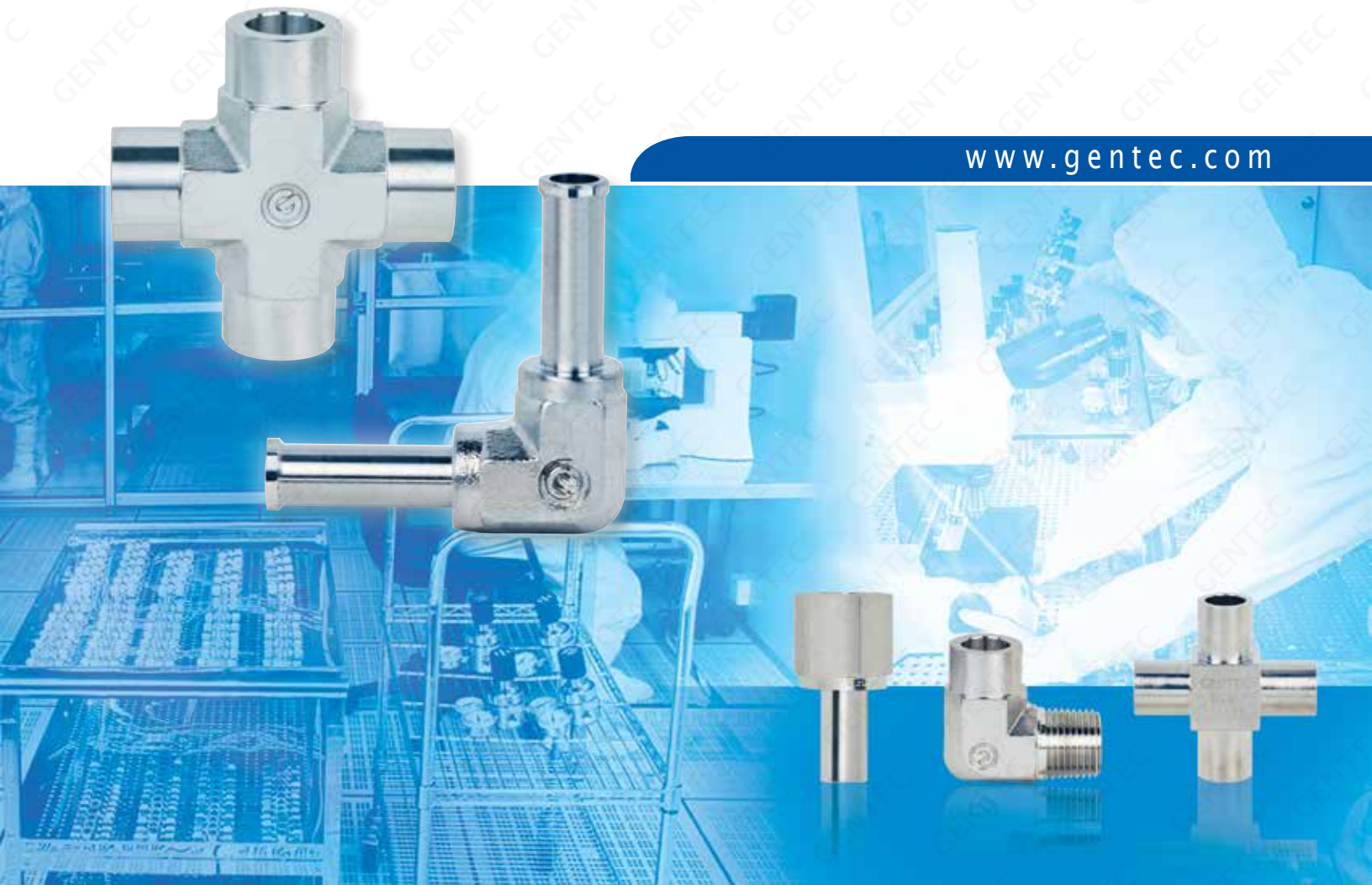

www.gentec.com



WELD FITTINGS

Solutions for Life



COMPANY HISTORY

Company Overview

Solutions for Life

Company Overview



Genstar Technologies is a global leader in Gas Flow Control Systems for the industrial, specialty gas and medical sectors. We pride ourselves in our ability to provide our customers with high quality, value-added products and services that go beyond the industry standards. As a result, we have a global network of thousands of satisfied customers in over 60 countries.

Our Team

Our highly educated team of engineers, salespeople, technicians, managers, and customer service personnel are dedicated to providing you with products with the highest quality, reliability and performance. We hold the highest standards to our manufacturing processes; our total process management maximizes our production efficiency while ensuring product quality.

We work closely with all of our customers to design products specific to your needs. This includes developing new products, redesigning existing products, and customizing configuration / packaging. It is our priority to foster a strong relationship with each and every customer.



Quality Assurance

All of our products are manufactured under stringent quality control. We are ISO 9001:2001 and API certified.

Our products meet UL, CE, SEMI, and various international standards and certifications.

Manufacturing Capabilities

The manufacturing facility is equipped with CNC machines, electro-polishing equipment, and precision automated orbital welding systems, among other features, to ensure the production of the highest quality products.

Clean Room Facilities

Our class 10/100/1000 clean rooms are designed for Ultra High Purity (UHP) products. UHP products undergo precision machining, surface finishing, electro-polishing and passivation. All UHP products are cleaned by 18M Ω DI water in a cascade ultrasonic tank. To ensure the highest UHP product quality, they are then vacuum-dried and double-bagged.

TABLE OF CONTENTS

Solutions for Life



Tube Weld Fittings

- 04. Tube Weld Male Connector
 - 05. Tube Weld Female Connector
 - 06. Tube Weld Reducer Union
 - 07. Tube Weld Union Elbow
 - 08. Tube Weld Union Tee
 - 09. Tube Weld Reducer Tee
 - 10. Tube Weld Union Cross
-



Butt Weld Fittings

- 11. Butt Weld Union
 - 11. Butt Weld Reducer Union
 - 12. Butt Weld Union Elbow
 - 13. Butt Weld Union Tee
 - 14. Butt Weld Reducer Tee
 - 15. Butt Weld Union Cross
-



Micro Weld Fittings

- 16. Micro Reducer Union
 - 16. Micro Union Elbow
 - 17. Micro Reducer Elbow
 - 17. Micro Union Tee
 - 18. Micro Reducer Tee
 - 18. Micro Union Cross
-



Socket Weld Fittings

- 19. Socket Weld Male Connector
- 19. Socket Weld Female Connector
- 20. Socket Weld Union
- 20. Socket Weld Male Elbow
- 21. Socket Weld Female Elbow
- 21. Socket Weld Union Elbow
- 22. Socket Weld Union Tee
- 22. Socket Weld Union Cross

■ Tube Weld Fittings

Flat End, Burrless

Seamless joint without burr
Ensure uniform pipe thickness

High Precision CNC Machining

Ensure that the inner diameter and pipe dimensions exactly matched

High Purity Application Processing

Surface finish up to 0.4 μm
Degreased for oxygen use



■ Butt Weld Fittings

High Precision CNC Machining

Ensure that the inner diameter and pipe dimensions exactly matched

High Purity Application Processing

Surface finish up to 0.4 μm
Degreased for oxygen use

Bayonet

Assist in alignment, convenient welding



■ Micro Weld Fittings

Flat End, Burrless

Seamless joint without burr
Ensure uniform pipe thickness

Sharp Corner Deburring

Effectively prevent accidental
injury to people or parts

Spherical Design

Smoother fluid flow
Eliminate the dead angle

High Purity Application Processing

BA: Surface finish up to 0.25 μm
EP: Surface finish up to 0.13 μm

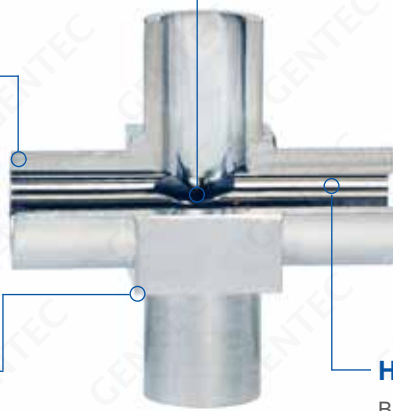

■ Socket Weld Fittings

High Precision CNC Machining

Ensure that the inner diameter and pipe
dimensions exactly matched

Thinner Wall Design

Reduce welding thermal deformation

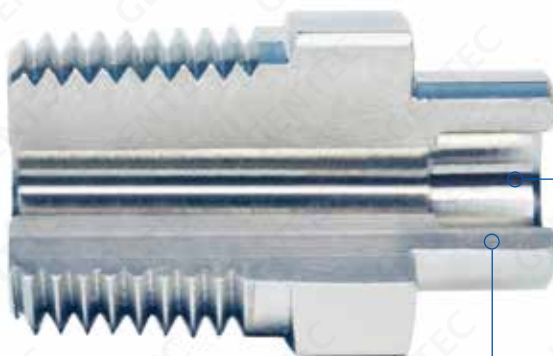

WELD FITTINGS

TWMC Series

Solutions for Life

■ Tube Weld Male Connector



Fractional

O.D. in.	Pipe Thickness in.	Male NPT in.	Model Number	Dimensions in.(mm)			Preset Pressure psi (bar)
				A	B	F	
1/4	0.035	1/8	SL- TWMC-4-NT2	1.40 (35.5)	0.75 (19)	7/16"	5100 (351)
1/4	0.035	1/4	SL- TWMC-4-NT4	1.58 (40.1)	0.75 (19)	9/16"	5100 (351)
1/4	0.035	3/8	SL- TWMC-4-NT6	1.64 (41.7)	0.75 (19)	11/16"	5100 (351)
3/8	0.035	1/4	SL- TWMC-6-NT4	1.58 (40.1)	0.75 (19)	9/16"	5100 (351)
3/8	0.035	3/8	SL- TWMC-6-NT6	1.64 (41.7)	0.75 (19)	11/16"	5100 (351)
3/8	0.035	1/2	SL- TWMC-6-NT8	1.85 (46.9)	0.75 (19)	7/8"	3300 (227)
1/2	0.049	1/4	SL- TWMC-8-NT4	1.58 (40.1)	0.75 (19)	9/16"	5100 (351)
1/2	0.049	3/8	SL- TWMC-8-NT6	1.64 (41.7)	0.75 (19)	11/16"	5100 (351)
1/2	0.049	1/2	SL- TWMC-8-NT8	1.85 (46.9)	0.75 (19)	7/8"	3300 (227)
3/4	0.049	1/2	SL- TWMC-12-NT8	1.85 (46.9)	0.75 (19)	7/8"	3300 (227)
3/4	0.049	3/4	SL- TWMC-12-NT12	1.84 (46.7)	0.75 (19)	1-1/16"	2400 (165)
1	0.065	3/4	SL- TWMC-16-NT12	1.84 (46.7)	0.75 (19)	1-1/16"	2400 (165)
1	0.065	1	SL- TWMC-16-NT16	2.17 (55.0)	0.75 (19)	1-3/8"	2400 (165)

Metric

O.D. mm	Pipe Thickness mm	Male NPT mm	Model Number	Dimensions mm (in.)			Preset Pressure MPa (psi)
				A	B	F	
6	1.0	1/8	SL- TWMC-6M-NT2	35.5 (1.40)	19 (0.75)	7/16"	35 (5100)
6	1.0	1/4	SL- TWMC-6M-NT4	40.1 (1.58)	19 (0.75)	9/16"	35 (5100)
8	1.0	1/4	SL-T WMC-8M-NT4	40.1 (1.58)	19 (0.75)	9/16"	35 (5100)
10	1.0	1/4	SL- TWMC-10M-NT4	40.1 (1.58)	19 (0.75)	9/16"	35 (5100)
10	1.0	3/8	SL- TWMC-10M-NT6	41.7 (1.64)	19 (0.75)	11/16"	35 (5100)
10	1.0	1/2	SL- TWMC-10M-NT8	46.9 (1.85)	19 (0.75)	7/8"	23 (3300)
12	1.0	1/4	SL- TWMC-12M-NT4	40.1 (1.58)	19 (0.75)	9/16"	35 (5100)
12	1.0	3/8	SL- TWMC-12M-NT6	41.7 (1.64)	19 (0.75)	11/16"	35 (5100)
12	1.0	1/2	SL- TWMC-12M-NT8	46.9 (1.85)	19 (0.75)	7/8"	23 (3300)

■ Tube Weld Female Connector



Fractional

O.D. in.	Pipe Thickness in.	Female NPT in.	Model Number	Dimensions in. (mm)			Preset Pressure psi (bar)
				A	B	F	
1/4	0.035	1/8	SL- TWFC-4-FNT2	1.38 (35.1)	0.75 (19)	9/16"	5100 (351)
1/4	0.035	1/4	SL- TWFC-4-FNT4	1.51 (38.4)	0.75 (19)	3/4"	5100 (351)
1/4	0.035	3/8	SL- TWFC-4-FNT6	1.50 (38.0)	0.75 (19)	7/8"	5100 (351)
3/8	0.035	1/4	SL- TWFC-6-FNT4	1.51 (38.4)	0.75 (19)	3/4"	3300 (227)
3/8	0.035	3/8	SL- TWFC-6-FNT6	1.50 (38.0)	0.75 (19)	7/8"	3300 (227)
3/8	0.035	1/2	SL- TWFC-6-FNT8	1.69 (43.0)	0.75 (19)	1-1/16"	3300 (227)
1/2	0.049	1/4	SL- TWFC-8-FNT4	1.42 (36.0)	0.75 (19)	3/4"	3700 (254)
1/2	0.049	3/8	SL- TWFC-8-FNT6	1.50 (38.0)	0.75 (19)	7/8"	3700 (254)
1/2	0.049	1/2	SL- TWFC-8-FNT8	1.69 (43.0)	0.75 (19)	1-1/16"	3700 (254)
3/4	0.049	1/2	SL- TWFC-12-FNT8	1.69 (43.0)	0.75 (19)	1-1/16"	2400 (165)
3/4	0.049	3/4	SL- TWFC-12-FNT12	1.78 (45.0)	0.75 (19)	1-5/16"	2400 (165)
1	0.065	3/4	SL- TWFC-16-FNT12	1.78 (45.0)	0.75 (19)	1-5/16"	2400 (165)
1	0.065	1	SL- TWFC-16-FNT16	2.01 (51.0)	0.75 (19)	1-5/8"	2400 (165)

Metric

O.D. mm	Pipe Thickness mm	Female NPT mm	Model Number	Dimensions mm (in.)			Preset Pressure MPa (psi)
				A	B	F	
6	1.0	1/8	SL- TWFC-6M-FNT2	35.1 (1.38)	19 (0.75)	9/16"	42 (6095)
6	1.0	1/4	SL- TWFC-6M-FNT4	36.0 (1.42)	19 (0.75)	3/4"	42 (6095)
8	1.0	1/4	SL- TWFC-8M-FNT4	36.0 (1.42)	19 (0.75)	3/4"	31 (4499)
10	1.0	1/4	SL- TWFC-10M-FNT4	36.0 (1.42)	19 (0.75)	3/4"	24 (3483)
10	1.0	3/8	SL- TWFC-10M-FNT6	38.0 (1.50)	19 (0.75)	7/8"	24 (3483)
10	1.0	1/2	SL- TWFC-10M-FNT8	43.0 (1.69)	19 (0.75)	1-1/16"	24 (3483)
12	1.0	1/4	SL- TWFC-12M-FNT4	38.4 (1.51)	19 (0.75)	3/4"	20 (2902)
12	1.0	3/8	SL- TWFC-12M-FNT6	38.0 (1.50)	19 (0.75)	7/8"	20 (2902)
12	1.0	1/2	SL- TWFC-12M-FNT8	43.0 (1.69)	19 (0.75)	1-1/16"	20 (2902)

WELD FITTINGS

TWRU Series

Solutions for Life

■ Tube Weld Reducer Union

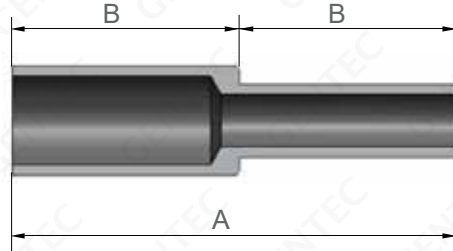

Fractional

O.D. 1 in.	Pipe Thickness 1 in.	O.D. 2 in.	Pipe Thickness 2 in.	Model Number	Dimensions in. (mm)		Preset Pressure psi (bar)
					A	B	
3/8	0.035	1/4	0.035	SL-TWRU-6-4	1.5 (38)	0.75 (19)	3300 (227)
1/2	0.049	1/4	0.035	SL-TWRU-8-4	1.5 (38)	0.75 (19)	3700 (254)
1/2	0.049	3/8	0.035	SL-TWRU-8-6	1.5 (38)	0.75 (19)	3300 (227)
3/4	0.049	1/2	0.049	SL-TWRU-12-8	1.5 (38)	0.75 (19)	2400 (165)
1	0.065	1/2	0.049	SL-TWRU-16-8	1.5 (38)	0.75 (19)	2400 (165)
1	0.065	3/4	0.049	SL-TWRU-16-12	1.5 (38)	0.75 (19)	2400 (165)

Metric

O.D. 1 mm	Pipe Thickness 1 mm	O.D. 2 mm	Pipe Thickness 2 mm	Model Number	Dimensions mm (in.)		Preset Pressure MPa (psi)
					A	B	
10	1.0	6	1.0	SL-TWRU-10M-6M	38 (1.5)	19 (0.75)	24 (3483)
10	1.0	8	1.0	SL-TWRU-10M-8M	38 (1.5)	19 (0.75)	24 (3483)
12	1.0	6	1.0	SL-TWRU-12M-6M	38 (1.5)	19 (0.75)	20 (2902)
12	1.0	8	1.0	SL-TWRU-12M-8M	38 (1.5)	19 (0.75)	20 (2902)
12	1.0	10	1.0	SL-TWRU-12M-10M	38 (1.5)	19 (0.75)	20 (2902)
18	1.5	6	1.0	SL-TWRU-18M-6M	38 (1.5)	19 (0.75)	20 (2902)
18	1.5	12	1.0	SL-TWRU-18M-12M	38 (1.5)	19 (0.75)	20 (2902)

■ Tube Weld Union Elbow

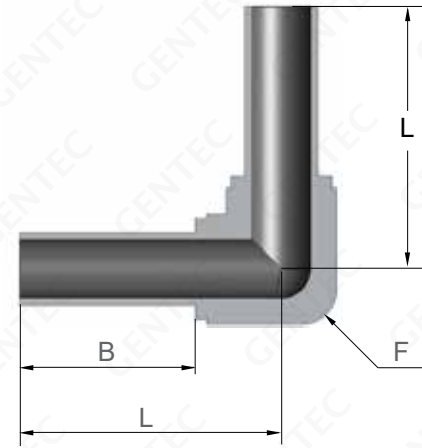

Fractional

O.D. in.	Pipe Thickness in.	Model Number	Dimensions in. (mm)			Preset Pressure psi (bar)
			B	F	L	
1/4	0.035	SL-TWUE-4	0.75 (19.0)	7/16"	1.23 (31.2)	5100 (351)
3/8	0.035	SL-TWUE-6	0.75 (19.0)	7/16"	1.20 (30.5)	3300 (227)
1/2	0.049	SL-TWUE-8	0.75 (19.0)	11/16"	1.34 (34.0)	3700 (254)
3/4	0.049	SL-TWUE-12	0.75 (19.0)	15/16"	1.46 (37.1)	2400 (165)

Metric

O.D. mm	Pipe Thickness mm	Model Number	Dimensions mm (in.)			Preset Pressure MPa (psi)
			B	F	L	
6	1	SL-TWUE-6M	19.0 (0.75)	7/16"	31.2 (1.23)	42 (6095)
8	1	SL-TWUE-8M	19.0 (0.75)	7/16"	31.2 (1.23)	31 (4499)
10	1	SL-TWUE-10M	19.0 (0.75)	11/16"	34 (1.34)	24 (3483)
12	1	SL-TWUE-12M	19.0 (0.75)	11/16"	34 (1.34)	20 (2902)
18	1.5	SL-TWUE-18M	19.0 (0.75)	15/16"	37.6 (1.48)	20 (2902)

WELD FITTINGS

TWUT Series

Solutions for Life

■ Tube Weld Union Tee

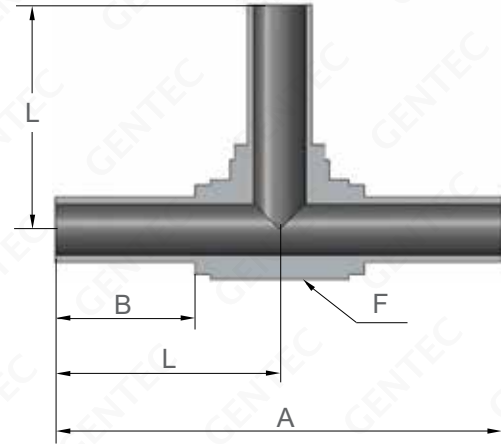

Fractional

O.D. in.	Pipe Thickness in.	Model Number	Dimensions in. (mm)				Preset Pressure psi (bar)
			A	B	F	L	
1/4	0.035	SL-TWUT-4	2.46 (62.5)	0.75 (19)	7/16"	1.23 (31.2)	5100 (351)
3/8	0.035	SL-TWUT-6	2.40 (61.0)	0.75 (19)	7/16"	1.20 (30.5)	3300 (227)
1/2	0.049	SL-TWUT-8	2.68 (68.1)	0.75 (19)	11/16"	1.34 (34.0)	3700 (254)
3/4	0.049	SL-TWUT-12	2.92 (74.2)	0.75 (19)	15/16"	1.46 (37.1)	2400 (165)

Metric

O.D. mm	Pipe Thickness mm	Model Number	Dimensions mm (in.)				Preset Pressure MPa (psi)
			A	B	F	L	
6	1.0	SL-TWUT-6M	62.5 (2.46)	19.0 (0.75)	7/16"	31.2 (1.23)	42 (6095)
8	1.0	SL-TWUT-8M	62.5 (2.46)	19.0 (0.75)	7/16"	31.2 (1.23)	31 (4499)
10	1.0	SL-TWUT-10M	68.0 (2.67)	19.0 (0.75)	11/16"	34.0 (1.34)	24 (3483)
12	1.0	SL-TWUT-12M	68.0 (2.67)	19.0 (0.75)	11/16"	34.0 (1.34)	20 (2902)
18	1.5	SL-TWUT-18M	75.2 (2.96)	19.0 (0.75)	15/16"	37.6 (1.48)	20 (2902)

■ Tube Weld Reducer Tee

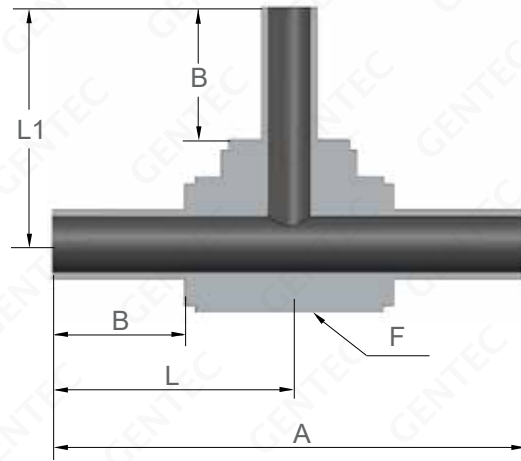

Fractional

O.D. 1 in.	Pipe Thickness 1 in.	O.D. 2 in.	Pipe Thickness 2 in.	Model Number	Dimensions in. (mm)					Preset Pressure psi (bar)
					A	B	F	L	L1	
3/8	0.035	1/4	0.035	SL-TWRT-6-4	2.40 (61.0)	0.75 (19)	7/16"	1.2 (30.5)	1.23 (31.2)	3300 (227)
1/2	0.049	1/4	0.035	SL-TWRT-8-4	2.68 (68.0)	0.75 (19)	11/16"	1.34 (34.0)	1.34 (34.0)	3700 (254)
1/2	0.049	3/8	0.035	SL-TWRT-8-6	2.68 (68.0)	0.75 (19)	11/16"	1.34 (34.0)	1.35 (34.3)	3300 (227)
3/4	0.049	3/8	0.035	SL-TWRT-12-6	2.92 (74.2)	0.75 (19)	15/16"	1.46 (37.1)	1.35 (34.3)	2400 (165)
3/4	0.049	1/2	0.035	SL-TWRT-12-8	2.92 (74.2)	0.75 (19)	15/16"	1.46 (37.1)	1.48 (37.6)	2400 (165)

Metric

O.D. 1 mm	Pipe Thickness 1 mm	O.D. 2 mm	Pipe Thickness 2 mm	Model Number	Dimensions mm (in.)					Preset Pressure MPa (psi)
					A	B	F	L	L1	
8	1.0	6.0	1.0	SL-TWRT-8M-6M	62.6 (2.46)	19 (0.75)	7/16"	31.3 (1.23)	31.3 (1.23)	31 (4499)
10	1.0	6.0	1.0	SL-TWRT-10M-6M	68.0 (2.68)	19 (0.75)	11/16"	34.0 (1.34)	34.0 (1.34)	24 (3483)
10	1.0	8.0	1.0	SL-TWRT-10M-8M	68.0 (2.68)	19 (0.75)	11/16"	34.0 (1.34)	34.0 (1.34)	20 (2902)
12	1.0	6.0	1.0	SL-TWRT-12M-6M	68.0 (2.68)	19 (0.75)	11/16"	34.0 (1.34)	34.0 (1.34)	20 (2902)
12	1.0	8.0	1.0	SL-TWRT-12M-8M	68.0 (2.68)	19 (0.75)	11/16"	34.0 (1.34)	34.0 (1.34)	20 (2902)

WELD FITTINGS

TWUC Series

Solutions for Life

■ Tube Weld Union Cross

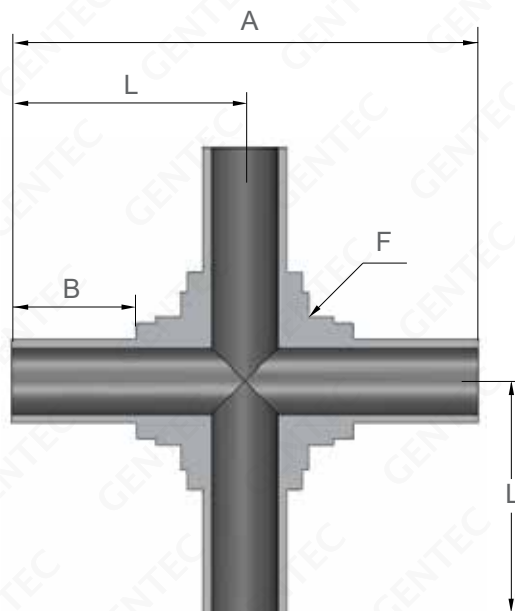

Fractional

O.D. in.	Pipe Thickness in.	Model Number	Dimensions in. (mm)				Preset Pressure psi (bar)
			A	B	F	L	
1/4	0.035	SL-TWUC-4	2.46 (62.4)	0.75 (19)	7/16"	1.23 (31.2)	5100 (351)
3/8	0.035	SL-TWUC-6	2.40 (61.0)	0.75 (19)	7/16"	1.20 (30.5)	3300 (227)
1/2	0.049	SL-TWUC-8	2.55 (64.8)	0.75 (19)	11/16"	1.27 (32.4)	3700 (254)

Metric

O.D. mm	Pipe Thickness mm	Model Number	Dimensions mm (in.)				Preset Pressure MPa (psi)
			A	B	F	L	
6	1.0	SL-TWUC-6M	62.6 (2.46)	19 (0.75)	7/16"	31.3 (1.23)	42 (6095)
8	1.0	SL-TWUC-8M	62.6 (2.46)	19 (0.75)	7/16"	31.3 (1.23)	31 (4499)
10	1.0	SL-TWUC-10M	64.8 (2.55)	19 (0.75)	5/8"	32.4 (1.27)	24 (3483)
12	1.0	SL-TWUC-12M	64.8 (2.55)	19 (0.75)	5/8"	32.4 (1.27)	20 (2902)

■ Butt Weld Union

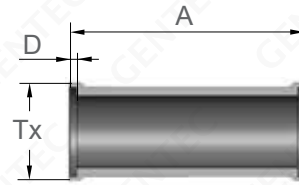

Fractional

O.D. in.	Pipe Thickness in.	Model Number	Dimensions in. (mm)			Preset Pressure psi (bar)
			A	D	Tx	
1/4	0.035	SL-BWU-4	1.00 (25.4)	0.02 (0.51)	0.29 (7.4)	5100 (351)
3/8	0.035	SL-BWU-6	1.00 (25.4)	0.03 (0.76)	0.41 (10.4)	3300 (227)
1/2	0.049	SL-BWU-8	1.00 (25.4)	0.04 (1.00)	0.55 (14.0)	3700 (254)
3/4	0.049	SL-BWU-12	1.00 (25.4)	0.04 (1.00)	0.80 (20.3)	2400 (165)
1	0.065	SL-BWU-16	1.25 (31.8)	0.04 (1.00)	1.06 (26.9)	2400 (165)

Metric

O.D. mm	Pipe Thickness mm	Model Number	Dimensions mm (in.)			Preset Pressure MPa (psi)
			A	D	Tx	
6	1.0	SL-BWU-6M	31.8 (1.25)	0.51 (0.02)	6.9 (0.27)	42 (6095)
8	1.0	SL-BWU-8M	31.8 (1.25)	0.76 (0.03)	8.9 (0.35)	31 (4499)
10	1.0	SL-BWU-10M	31.8 (1.25)	0.76 (0.03)	10.9 (0.43)	24 (3483)
12	1.0	SL-BWU-12M	31.8 (1.25)	1.00 (0.04)	13.2 (0.52)	20 (2902)
18	1.5	SL-BWU-18M	31.8 (1.25)	1.00 (0.04)	19.3 (0.76)	20 (2902)

■ Butt Weld Reducer Union

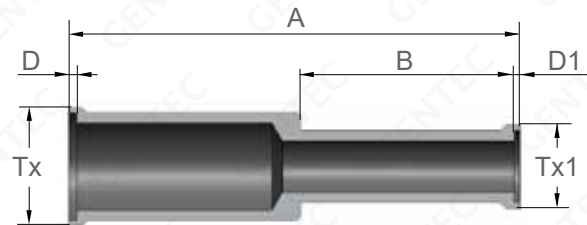

Fractional

O.D. 1 in.	Pipe Thickness 1 in.	O.D. 2 in.	Pipe Thickness 2 in.	Model Number	Dimensions in. (mm)						Preset Pressure psi (bar)
					A	B	D	D1	Tx	Tx1	
3/8	0.035	1/4	0.035	SL-BWRU-6-4	1.58 (40.1)	0.75 (19)	0.03 (0.76)	0.02 (0.51)	0.41 (10.4)	0.29 (7.4)	3300 (227)
1/2	0.049	1/4	0.035	SL-BWRU-8-4	1.58 (40.1)	0.75 (19)	0.04 (1.00)	0.02 (0.51)	0.55 (14.0)	0.29 (7.4)	3700 (254)
1/2	0.049	3/8	0.035	SL-BWRU-8-6	1.58 (40.1)	0.75 (19)	0.04 (1.00)	0.03 (0.76)	0.55 (14.0)	0.41 (10.4)	3300 (227)
3/4	0.049	1/2	0.049	SL-BWRU-12-8	1.62 (41.1)	0.75 (19)	0.04 (1.00)	0.04 (1.00)	0.80 (20.3)	0.55 (14.0)	2400 (165)

Metric

O.D. 1 mm	Pipe Thickness 1 mm	O.D. 2 mm	Pipe Thickness 2 mm	Model Number	Dimensions mm (in.)						Preset Pressure MPa (psi)
					A	B	D	D1	Tx	Tx1	
8	1.0	6	1.0	SL-BWRU-8M-6M	39.9 (1.57)	19 (0.75)	0.76 (0.03)	0.51 (0.02)	8.90 (0.35)	6.8 (0.27)	31 (4499)
12	1.0	6	1.0	SL-BWRU-12M-6M	40.1 (1.58)	19 (0.75)	1.00 (0.04)	0.51 (0.02)	13.2 (0.52)	6.8 (0.27)	20 (2902)
12	1.0	8	1.0	SL-BWRU-12M-8M	40.4 (1.59)	19 (0.75)	1.00 (0.04)	0.76 (0.03)	13.2 (0.52)	8.9 (0.35)	20 (2902)

WELD FITTINGS

BWUE Series

Solutions for Life

■ Butt Weld Union Elbow

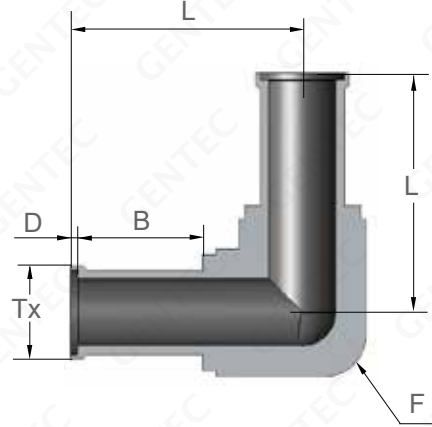

Fractional

O.D. in.	Pipe Thickness in.	Model Number	Dimensions in. (mm)					Preset Pressure psi (bar)
			B	D	F	L	Tx	
1/4	0.035	SL-BWUE-4	0.75 (19.0)	0.02 (0.51)	7/16"	1.25 (31.8)	0.29 (7.4)	5100 (351)
3/8	0.035	SL-BWUE-6	0.75 (19.0)	0.03 (0.76)	7/16"	1.23 (31.2)	0.41 (10.4)	3300 (227)
1/2	0.049	SL-BWUE-8	0.75 (19.0)	0.04 (1.00)	11/16"	1.38 (35.1)	0.55 (14.0)	3700 (254)
3/4	0.049	SL-BWUE-12	0.75 (19.0)	0.04 (1.00)	15/16"	1.50 (38.1)	0.80 (20.3)	2400 (165)
1	0.065	SL-BWUE-16	0.96 (24.4)	0.04 (1.00)	3/4"	1.89 (48.0)	1.06 (26.9)	2400 (165)

Metric

O.D. mm	Pipe Thickness mm	Model Number	Dimensions mm (in.)					Preset Pressure MPa (psi)
			B	D	F	L	Tx	
6	1.0	SL-BWUE-6M	19 (0.75)	0.51 (0.02)	7/16"	31.8 (1.25)	6.9 (0.27)	35 (5100)
8	1.0	SL-BWUE-8M	19 (0.75)	0.76 (0.03)	7/16"	32.0 (1.26)	8.9 (0.35)	23 (3300)
10	1.0	SL-BWUE-10M	19 (0.75)	0.76 (0.03)	11/16"	34.8 (1.37)	10.9 (0.43)	25 (3700)
12	1.0	SL-BWUE-12M	19 (0.75)	1.00 (0.04)	11/16"	35.1 (1.38)	13.2 (0.52)	20 (2888)
18	1.5	SL-BWUE-18M	19 (0.75)	1.00 (0.04)	15/16"	38.6 (1.52)	19.3 (0.76)	21 (2989)

■ Butt Weld Union Tee

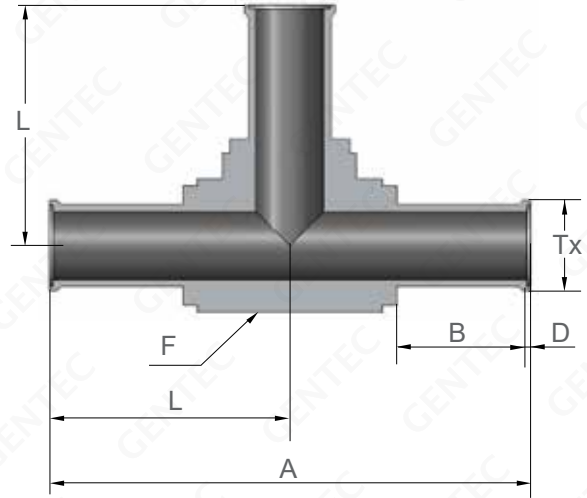

Fractional

O.D. in.	Pipe Thickness in.	Model Number	Dimensions in. (mm)						Preset Pressure psi (bar)
			A	B	D	F	L	Tx	
1/4	0.035	SL-BWUT-4	2.50 (63.5)	0.75 (19.0)	0.02 (0.51)	7/16"	1.25 (31.8)	0.29 (7.4)	5100 (351)
3/8	0.035	SL-BWUT-6	2.46 (62.5)	0.75 (19.0)	0.03 (0.76)	7/16"	1.23 (31.2)	0.41 (10.4)	3300 (227)
1/2	0.049	SL-BWUT-8	2.76 (70.1)	0.75 (19.0)	0.04 (1.00)	11/16"	1.38 (35.1)	0.55 (14.0)	3500 (241)
3/4	0.049	SL-BWUT-12	3.00 (76.2)	0.75 (19.0)	0.04 (1.00)	11/16"	1.50 (38.1)	0.80 (20.3)	2400 (165)
1	0.065	SL-BWUT-16	3.78 (96.0)	0.96 (24.4)	0.04 (1.00)	15/16"	1.89 (48.0)	1.06 (26.9)	2400 (165)

Metric

O.D. mm	Pipe Thickness mm	Model Number	Dimensions mm (in.)						Preset Pressure MPa (psi)
			A	B	D	F	L	Tx	
6	1.0	SL-BWUT-6M	63.5 (2.50)	19 (0.75)	0.51 (0.02)	7/16"	31.8 (1.25)	6.9 (0.27)	45 (6589)
8	1.0	SL-BWUT-8M	64.0 (2.52)	19 (0.75)	0.76 (0.03)	7/16"	32.0 (1.26)	8.9 (0.35)	32 (4687)
10	1.0	SL-BWUT-10M	69.6 (2.74)	19 (0.75)	0.76 (0.03)	11/16"	34.8 (1.37)	10.9 (0.43)	25 (3686)
12	1.0	SL-BWUT-12M	70.1 (2.76)	19 (0.75)	1.0 (0.04)	11/16"	35.1 (1.38)	13.2 (0.52)	21 (2989)
18	1.5	SL-BWUT-18M	77.2 (3.04)	19 (0.75)	1.0 (0.04)	15/16"	38.6 (1.52)	19.3 (0.76)	21 (2989)

WELD FITTINGS

BWRT Series

Solutions for Life

■ Butt Weld Reducer Tee

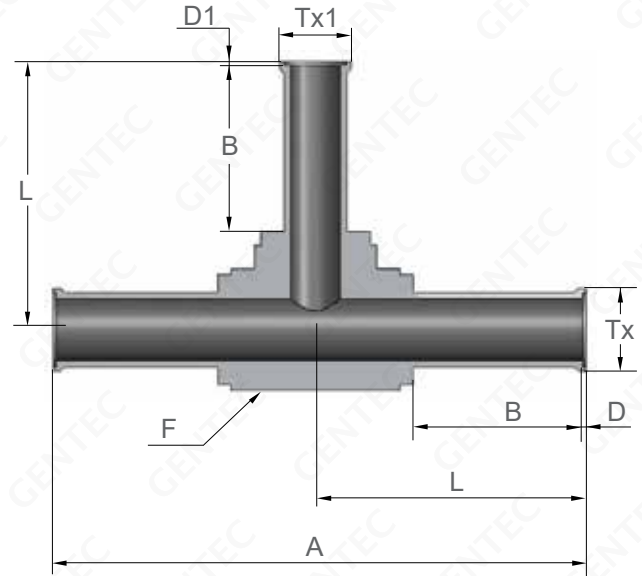

Fractional

O.D. 1 in.	Pipe Thickness 1 in.	O.D. 2 in.	Pipe Thickness 2 in.	Model Number	Dimensions in. (mm)							Preset Pressure psi (bar)
					A	B	D	D1	F	Tx	Tx1	
3/8	0.035	1/4	0.035	SL-BWRT-6-4	2.46 (62.5)	0.75 (19)	0.03 (0.76)	0.02 (0.51)	7/16"	0.41 (10.4)	0.29 (7.4)	3300 (227)
1/2	0.049	1/4	0.035	SL-BWRT-8-4	2.76 (70.0)	0.75 (19)	0.04 (1.00)	0.02 (0.51)	11/16"	0.55 (14.0)	0.29 (7.4)	3700 (254)
1/2	0.049	3/8	0.035	SL-BWRT-8-6	2.76 (70.0)	0.75 (19)	0.04 (1.00)	0.03 (0.76)	11/16"	0.55 (14.0)	0.41 (10.4)	3300 (227)
3/4	0.049	3/8	0.035	SL-BWRT-12-8	3.00 (76.2)	0.75 (19)	0.04 (1.00)	0.03 (0.76)	15/16"	0.80 (20.3)	0.41 (10.4)	2400 (165)
3/4	0.049	1/2	0.049	SL-BWRT-12-4	3.00 (76.2)	0.75 (19)	0.04 (1.00)	0.04 (1.00)	15/16"	0.80 (20.3)	0.55 (14.0)	2400 (165)

Metric

O.D. 1 mm	Pipe Thickness 1 mm	O.D. 2 mm	Pipe Thickness 2 mm	Model Number	Dimensions mm (in.)							Preset Pressure MPa (psi)
					A	B	D	D1	F	Tx	Tx1	
12	1.0	6	1.0	SL-BWRT-12M-6M	70 (2.76)	19.0 (0.75)	0.51 (0.02)	0.51 (0.02)	11/16"	13.2 (0.52)	6.9 (0.27)	20 (2902)

■ Butt Weld Union Cross

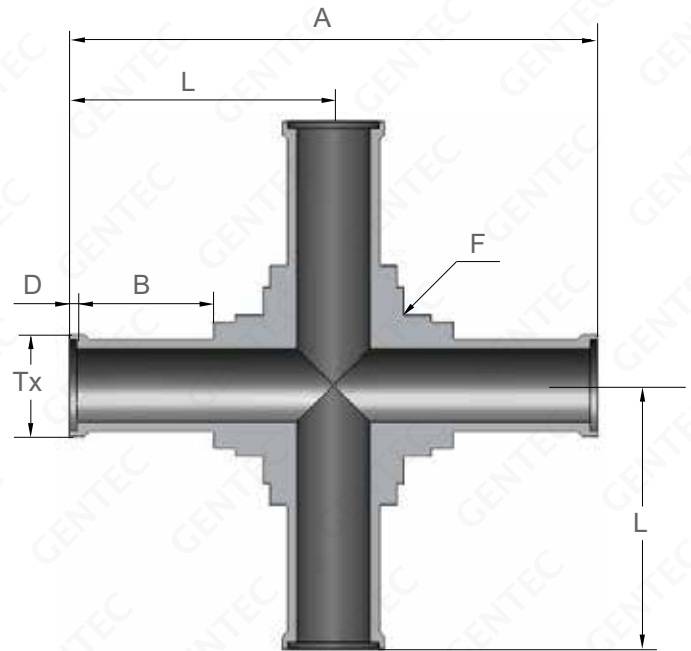

Fractional

O.D. in.	Pipe Thickness in.	Model Number	Dimensions in. (mm)						Preset Pressure psi (bar)
			A	B	D	F	L	Tx	
1/4	0.035	SL-BWUC-4	2.50 (63.5)	0.75 (19.0)	0.02 (0.51)	7/16"	1.25 (31.8)	0.29 (7.4)	5100 (351)
3/8	0.035	SL-BWUC-6	2.46 (62.5)	0.75 (19.0)	0.03 (0.76)	7/16"	1.23 (31.2)	0.41 (10.4)	3300 (227)
1/2	0.049	SL-BWUC-8	2.70 (68.6)	0.75 (19.0)	0.04 (1.00)	5/8"	1.35 (34.3)	0.55 (14.0)	3700 (254)

Metric

O.D. mm	Pipe Thickness mm	Model Number	Dimensions mm (in.)						Preset Pressure MPa (psi)
			A	B	D	F	L	Tx	
6	1.0	SL-BWUC-6M	63.5 (2.50)	19.0 (0.75)	0.51 (0.02)	7/16"	31.8 (1.25)	6.9 (0.27)	42 (6095)
8	1.0	SL-BWUC-8M	63.5 (2.50)	19.0 (0.75)	0.76 (0.03)	7/16"	31.8 (1.25)	8.9 (0.35)	31 (4499)

WELD FITTINGS

MRU Series, MUE Series

Solutions for Life

■ Micro Reducer Union

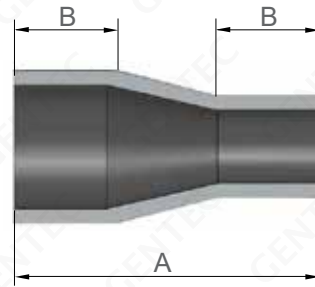

Fractional

O.D. 1 in.	Pipe Thickness 1 in.	O.D. 2 in.	Pipe Thickness 2 in.	Model Number	Dimensions in. (mm)		Preset Pressure psi (bar)
					A	B	
1/4	1/8	1/8		SL-MRU-4-2	0.75 (19)	0.25 (6.4)	5100 (351)
3/8	1/4	1/4		SL-MRU-6-4	0.75 (19)	0.25 (6.4)	3300 (227)
1/2	1/4	1/4		SL-MRU-8-4	0.75 (19)	0.25 (6.4)	3700 (254)
1/2	3/8	3/8		SL-MRU-8-6	0.75 (19)	0.25 (6.4)	3300 (227)

■ Micro Union Elbow

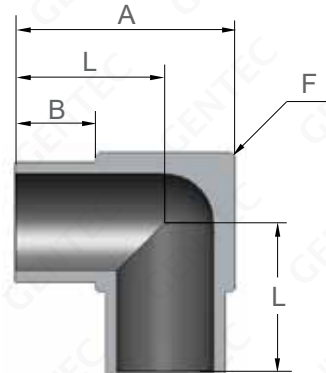

Fractional

O.D. in.	Pipe Thickness in.	Model Number	Dimensions in. (mm)				Preset Pressure psi (bar)
			A	B	F	L	
1/8	0.028	SL-MUE-2	0.44 (11.1)	0.25 (6.4)	5/16"	0.34 (8.75)	8500 (585)
1/4	0.035	SL-MUE-4	0.56 (14.2)	0.25 (6.4)	5/16"	0.41 (10.4)	5100 (351)
3/8	0.035	SL-MUE-6	0.69 (17.5)	0.25 (6.4)	7/16"	0.47 (11.9)	3300 (227)
1/2	0.049	SL-MUE-8	0.81 (20.6)	0.25 (6.4)	9/16"	0.53 (13.5)	3700 (254)

Metric

O.D. mm	Pipe Thickness mm	Model Number	Dimensions mm (in.)				Preset Pressure MPa (psi)
			A	B	F	L	
6	1.0	SL-MUE-6M	14.2 (0.56)	6.4 (0.25)	5/16"	10.4 (0.41)	42 (6095)
8	1.0	SL-MUE-8M	17.5 (0.69)	6.4 (0.25)	7/16"	11.9 (0.47)	31 (4499)
10	1.0	SL-MUE-10M	17.5 (0.69)	6.4 (0.25)	7/16"	11.9 (0.47)	24 (3483)
12	1.0	SL-MUE-12M	20.6 (0.81)	6.4 (0.25)	9/16"	13.5 (0.53)	20 (2902)

WELD FITTINGS

Solutions for Life

MRE Series, MUT Series

Micro Reducer Elbow

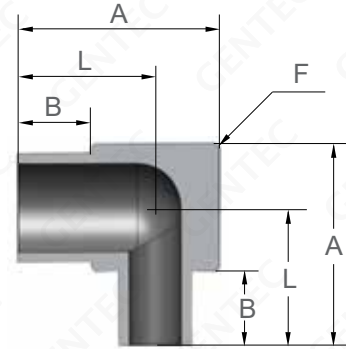

Fractional

O.D. 1 in.	Pipe Thickness 1 in.	O.D. 2 in.	Pipe Thickness 2 in.	Model Number	Dimensions in.(mm)				Preset Pressure psi (bar)
					A	B	F	L	
3/8	0.035	1/4	0.035	SL-MRE-6-4	0.69 (17.5)	0.25 (6.4)	7/16"	0.47 (11.9)	3300 (227)
1/2	0.049	1/4	0.035	SL-MRE-8-4	0.81 (20.6)	0.25 (6.4)	9/16"	0.53 (13.5)	3700 (254)
1/2	0.049	3/8	0.035	SL-MRE-8-6	0.81 (20.6)	0.25 (6.4)	9/16"	0.53 (13.5)	3300 (227)

Metric

O.D. 1 mm	Pipe Thickness 1 mm	O.D. 2 mm	Pipe Thickness 2 mm	Model Number	Dimensions mm(in.)				Preset Pressure MPa (psi)
					A	B	F	L	
8	1.0	6	1.0	SL-MRE-8M-6M	17.5 (0.69)	6.4 (0.25)	7/16"	11.9 (0.47)	31 (4499)
10	1.0	6	1.0	SL-MRE-10M-6M	17.5 (0.69)	6.4 (0.25)	7/16"	11.9 (0.47)	24 (3483)
12	1.0	6	1.0	SL-MRE-12M-6M	20.6 (0.81)	6.4 (0.25)	9/16"	13.5 (0.53)	20 (2902)
12	1.0	8	1.0	SL-MRE-12M-8M	20.6 (0.81)	6.4 (0.25)	9/16"	13.5 (0.53)	20 (2902)

Micro Union Tee

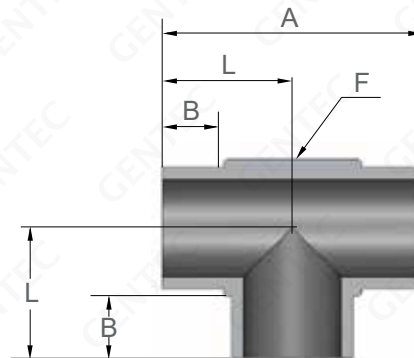

Fractional

O.D. in.	Pipe Thickness in.	Model Number	Dimensions in.(mm)				Preset Pressure MPa (psi)
			A	B	F	L	
1/4	0.035	SL-MUT-4	0.82 (20.83)	0.25 (6.35)	5/16"	0.41 (10.41)	5100 (351)
3/8	0.035	SL-MUT-6	0.94 (23.88)	0.25 (6.35)	7/16"	0.47 (11.94)	3300 (227)
1/2	0.049	SL-MUT-8	1.06 (26.93)	0.25 (6.35)	9/16"	0.53 (13.46)	3700 (254)

Metric

O.D. mm	Pipe Thickness mm	Model Number	Dimensions mm (in.)				Preset Pressure MPa (psi)
			A	B	F	L	
6	1.0	SL-MUT-6M	20.8 (0.80)	6.4 (0.25)	5/16"	10.4 (0.41)	42 (6095)
8	1.0	SL-MUT-8M	23.8 (0.94)	6.4 (0.25)	7/16"	11.9 (0.47)	31 (4499)
10	1.0	SL-MUT-10M	23.8 (0.94)	6.4 (0.25)	7/16"	11.9 (0.47)	24 (3483)
12	1.0	SL-MUT-12M	27.0 (1.06)	6.4 (0.25)	9/16"	13.5 (0.53)	20 (2902)

WELD FITTINGS

MRT Series, MUC Series

Solutions for Life

Micro Reducer Tee

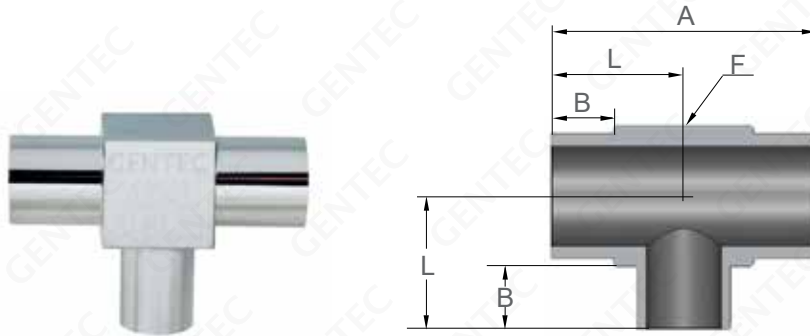

Fractional

O.D. 1 in.	Pipe Thickness 1 in.	O.D. 2 in.	Pipe Thickness 2 in.	Model Number	Dimensions in. (mm)				Preset Pressure psi (bar)
					A	B	F	L	
3/8	0.035	1/4	0.035	SL-MRT-6-4	0.94 (23.9)	0.25 (6.4)	7/16"	0.47 (11.9)	3300 (227)
1/2	0.049	1/4	0.035	SL-MRT-8-4	1.06 (26.9)	0.25 (6.4)	9/16"	0.53 (13.5)	3700 (254)
1/2	0.049	3/8	0.035	SL-MRT-8-6	1.06 (26.9)	0.25 (6.4)	9/16"	0.53 (13.5)	3000 (207)

Metric

O.D. 1 mm	Pipe Thickness 1 mm	O.D. 2 mm	Pipe Thickness 2 mm	Model Number	Dimensions mm (in.)				Preset Pressure MPa (psi)
					A	B	F	L	
10	1.0	6	1.0	SL-MRT-10M-6M	23.8 (0.94)	6.4 (0.25)	7/16"	11.9 (0.47)	24 (3483)
12	1.0	6	1.0	SL-MRT-12M-6M	26.9 (1.06)	6.4 (0.25)	9/16"	13.5 (0.53)	20 (2900)
12	1.0	8	1.0	SL-MRT-12M-8M	26.9 (1.06)	6.4 (0.25)	9/16"	13.5 (0.53)	20 (2900)

Micro Union Cross

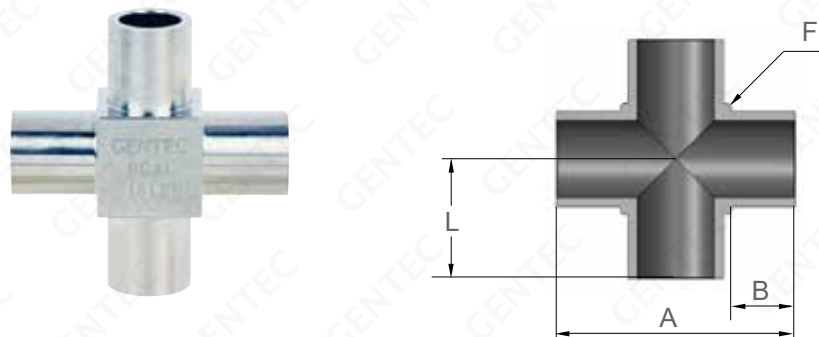

Fractional

O.D. in.	Pipe Thickness in.	Model Number	Dimensions in. (mm)				Preset Pressure psi (bar)
			A	B	F	L	
1/8	0.028	SL-MUC-2	0.69 (17.5)	0.25 (6.4)	5/16"	0.35 (8.7)	8500 (585)
1/4	0.035	SL-MUC-4	0.82 (20.8)	0.25 (6.4)	5/16"	0.41 (10.4)	5100 (351)
3/8	0.035	SL-MUC-6	0.94 (23.9)	0.25 (6.4)	7/16"	0.47 (11.9)	3300 (227)
1/8	0.049	SL-MUC-8	1.06 (26.9)	0.25 (6.4)	9/16"	0.53 (13.5)	3700 (254)

Metric

O.D. mm	Pipe Thickness mm	Model Number	Dimensions mm (in.)				Preset Pressure MPa (psi)
			A	B	F	L	
6	1.0	SL-MUC-6M	20.8 (0.82)	6.4 (0.25)	5/16"	10.4 (0.41)	42 (6095)
8	1.0	SL-MUC-8M	23.9 (0.94)	6.4 (0.25)	7/16"	11.9 (0.47)	31 (4499)
10	1.0	SL-MUC-10M	23.9 (0.94)	6.4 (0.25)	7/16"	11.9 (0.47)	24 (3483)
12	1.0	SL-MUC-12M	26.9 (1.06)	6.4 (0.25)	9/16"	13.5 (0.53)	20 (2902)

■ Socket Weld Male Connector

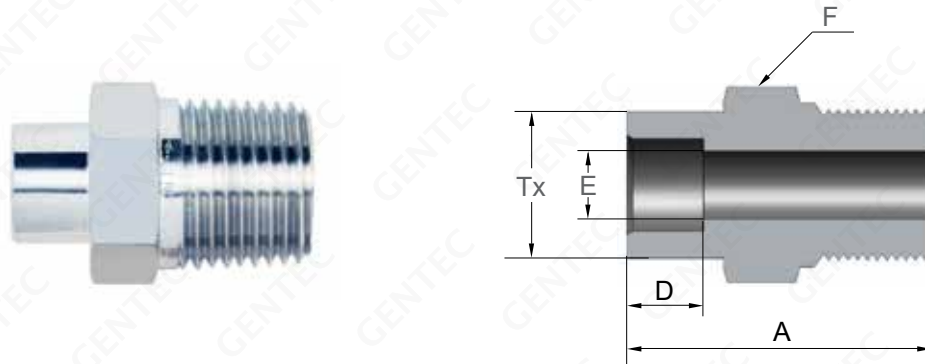

Fractional

Socket Size in.	Male NPT in.	Model Number	Dimensions in. (mm)					Preset Pressure psi (bar)
			A	D	E	F	Tx	
1/4	1/4	SS-SWMC-4-NT4	1.15 (29.2)	0.28 (7.1)	0.19 (4.8)	9/16"	0.48 (12.2)	8000 (551)
3/8	1/4	SS-SWMC-6-NT4	1.25 (31.8)	0.31 (7.9)	0.28 (7.1)	5/8"	0.60 (15.2)	8000 (551)
3/8	3/8	SS-SWMC-6-NT6	1.25 (31.8)	0.31 (7.9)	0.28 (7.1)	11/16"	0.60 (15.2)	7800 (537)
3/8	1/2	SS-SWMC-6-NT8	1.47 (37.3)	0.31 (7.9)	0.28 (7.1)	7/8"	0.60 (15.2)	7700 (530)
1/2	1/4	SS-SWMC-8-NT4	1.31 (33.3)	0.38 (9.7)	0.28 (7.1)	3/4"	0.73 (18.5)	6600 (454)
1/2	3/8	SS-SWMC-8-NT6	1.31 (33.3)	0.38 (9.7)	0.38 (9.7)	3/4"	0.73 (18.5)	6600 (454)
1/2	1/2	SS-SWMC-8-NT8	1.53 (38.9)	0.38 (9.7)	0.41 (10.4)	7/8"	0.73 (18.5)	6600 (454)

■ Socket Weld Female Connector

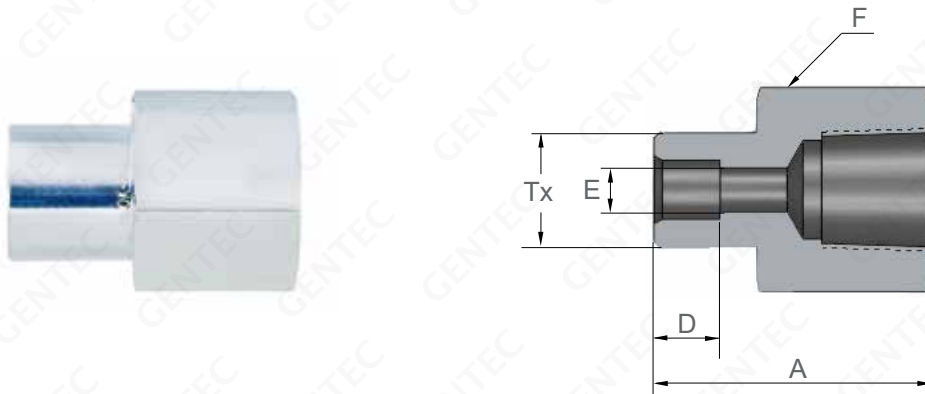

Fractional

Socket Size in.	Male NPT in.	Model Number	Dimensions in. (mm)					Preset Pressure psi (bar)
			A	D	E	F	Tx	
1/8	1/8	SS-SWFC-2-FNT2	0.83 (21.1)	0.10 (2.5)	0.09 (2.3)	9/16"	0.29 (7.4)	6500 (447)
1/4	1/8	SS-SWFC-4-FNT2	1.05 (26.7)	0.28 (7.1)	0.19 (4.8)	9/16"	0.48 (12.2)	6500 (447)
1/4	1/4	SS-SWFC-4-FNT4	1.18 (30.0)	0.28 (7.1)	0.19 (4.8)	3/4"	0.48 (12.2)	6600 (454)
3/8	1/4	SS-SWFC-6-FNT4	1.24 (31.5)	0.31 (7.9)	0.28 (7.1)	3/4"	0.60 (15.2)	6600 (454)
1/2	3/8	SS-SWFC-8-FNT6	1.36 (34.5)	0.38 (9.7)	0.41 (10.4)	7/8"	0.73 (18.5)	5300 (365)
1/2	1/2	SS-SWFC-8-FNT8	1.59 (40.4)	0.38 (9.7)	0.41 (10.4)	1-1/16"	0.73 (18.5)	4900 (337)
3/4	3/4	SS-SWFC-12-FNT12	1.73 (43.9)	0.44 (11.2)	0.63 (16)	1-5/16"	1.04 (26.4)	4600 (316)

WELD FITTINGS

SWU Series, SWME Series

Solutions for Life

■ Socket Weld Union

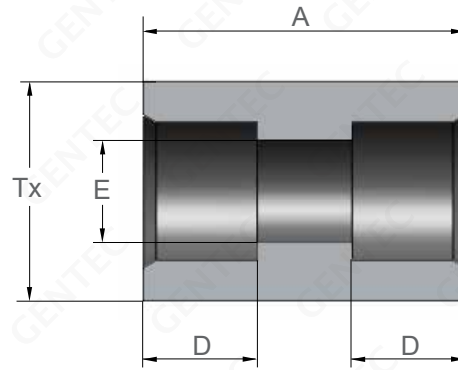

Fractional

Socket Size in.	Model Number	Dimensions in. (mm)				Preset Pressure psi (bar)
		A	D	E	Tx	
1/4	SS-SWU-4	0.75 (19.1)	0.28 (7.1)	0.19 (4.8)	0.48 (12.2)	10700 (737)
3/8	SS-SWU-6	0.88 (22.4)	0.31 (7.9)	0.28 (7.1)	0.60 (15.2)	8100 (558)
1/2	SS-SWU-8	1.06 (26.9)	0.38 (9.7)	0.41 (10.4)	0.73 (18.5)	6600 (454)
3/4	SS-SWU-12	1.31 (33.3)	0.44 (11.2)	0.63 (16.0)	1.04 (26.4)	5900 (406)
1	SS-SWU-16	1.44 (36.6)	0.62 (15.7)	0.88 (22.4)	1.36 (34.2)	5600 (385)

■ Socket Weld Male Elbow

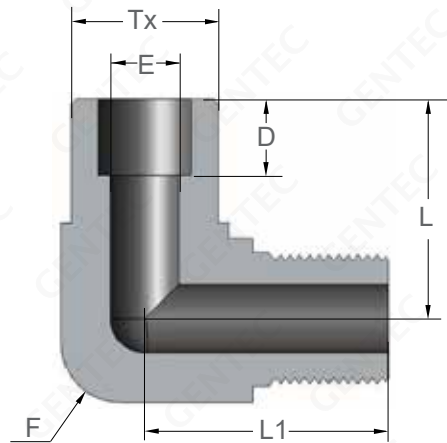

Fractional

Socket Size in.	Male NPT in.	Model Number	Dimensions in. (mm)						Preset Pressure psi (bar)
			D	E	F	L	L1	Tx	
1/4	1/4	SS-SWME-4-NT4	0.28 (7.1)	0.19 (4.8)	5/8"	0.90 (23)	1.00 (25.4)	0.48 (12.2)	8000 (551)
3/8	1/4	SS-SWME-6-NT4	0.31 (7.9)	0.28 (7.1)	5/8"	0.90 (23)	1.00 (25.4)	0.60 (15.2)	8000 (551)
3/8	3/8	SS-SWME-6-NT6	0.31 (7.9)	0.28 (7.1)	13/16"	0.98 (25)	1.03 (26.2)	0.60 (15.2)	7800 (537)
3/8	1/2	SS-SWME-6-NT8	0.31 (7.9)	0.28 (7.1)	15/16"	1.02 (26)	1.38 (35.1)	0.60 (15.2)	7700 (530)
1/2	1/2	SS-SWME-8-NT8	0.38 (9.7)	0.41 (10.4)	15/16"	1.08 (27.5)	1.38 (35.1)	0.73 (18.5)	6600 (454)

■ Socket Weld Female Elbow

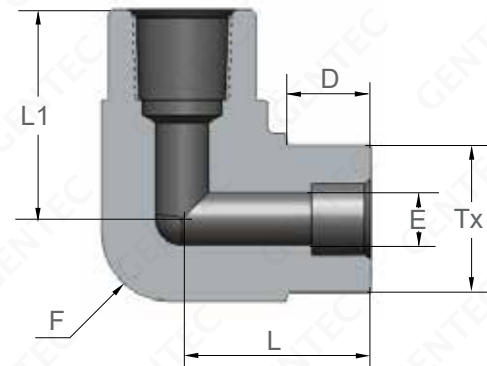

Fractional

Socket Size in.	Male NPT in.	Model Number	Dimensions in. (mm)						Preset Pressure psi (bar)
			D	E	F	L	L1	Tx	
1/4	1/4	SS-SWFE-4-FNT4	0.28 (7.1)	0.19 (4.8)	13/16"	0.90 (22.9)	1.11 (28.2)	0.77 (19.6)	7400 (509)
3/8	1/4	SS-SWFE-6-FNT4	0.31 (7.9)	0.28 (7.1)	13/16"	0.99 (25.1)	1.11 (28.2)	0.77 (19.6)	7400 (509)
3/8	1/2	SS-SWFE-6-FNT8	0.31 (7.9)	0.28 (7.1)	1-1/8"	1.13 (28.7)	1.46 (37.0)	1.08 (27.5)	5700 (392)
1/2	1/2	SS-SWFE-8-FNT8	0.38 (9.7)	0.41 (10.4)	1-1/8"	1.19 (30.0)	1.46 (37.0)	1.08 (27.5)	5700 (392)

■ Socket Weld Union Elbow

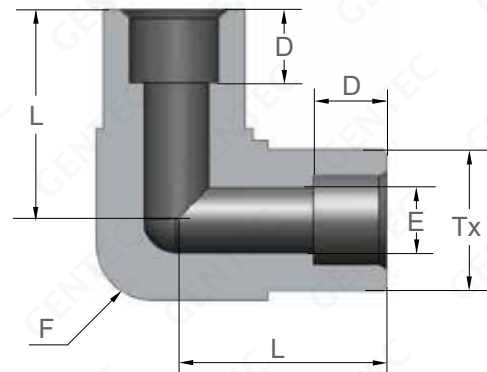

Fractional

Socket Size in.	Model Number	Dimensions in. (mm)					Preset Pressure psi (bar)
		D	E	F	L	Tx	
1/4	SS-SWUE-4	0.28 (7.1)	0.19 (4.7)	1/2"	0.78 (19.8)	0.47 (12.0)	10700 (737)
3/8	SS-SWUE-6	0.31 (7.9)	0.28 (7.1)	5/8"	0.90 (23.0)	0.60 (15.2)	8100 (558)
1/2	SS-SWUE-8	0.38 (9.7)	0.41 (10.4)	13/16"	1.00 (25.5)	0.76 (19.5)	6600 (454)
3/4	SS-SWUE-12	0.44 (11.2)	0.63 (15.9)	1-1/16"	1.16 (29.5)	1.08 (27.5)	5900 (406)
1	SS-SWUE-16	0.62 (15.7)	0.88 (22.2)	1-3/8"	1.45 (36.8)	1.34 (34.0)	5600 (385)

WELD FITTINGS

SWUT Series, SWUC Series

Solutions for Life

■ Socket Weld Union Tee

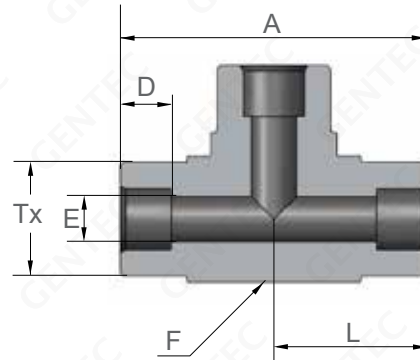

Fractional

Socket Size in.	Model Number	Dimensions in. (mm)						Preset Pressure psi (bar)
		A	D	E	F	L	Tx	
1/8	SS-SWUT-2	1.18 (30.0)	0.10 (2.5)	0.09 (2.3)	3/8"	0.61 (15.0)	0.35 (8.6)	12600 (866)
1/4	SS-SWUT-4	1.50 (38.0)	0.28 (7.1)	0.19 (4.7)	5/8"	0.75 (19.0)	0.62 (15.2)	10700 (737)
3/8	SS-SWUT-6	1.87 (47.5)	0.31 (7.9)	0.28 (7.1)	5/8"	0.97 (23.8)	0.62 (15.2)	8100 (558)
1/2	SS-SWUT-8	2.10 (53.5)	0.38 (9.7)	0.41 (10.4)	13/16"	1.09 (26.8)	0.80 (19.5)	6600 (454)
3/4	SS-SWUT-12	2.60 (66.0)	0.44 (11.2)	0.63 (15.9)	1-1/8"	1.35 (33.0)	1.12 (27.5)	5900 (406)
1	SS-SWUT-16	2.87 (73.0)	0.62 (15.7)	0.88 (22.2)	1-3/8"	1.49 (36.5)	1.40 (34.2)	5600 (385)

■ Socket Weld Union Cross

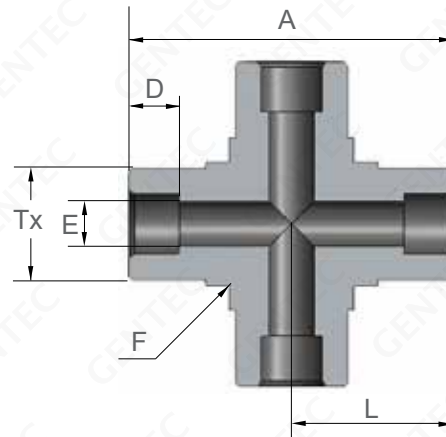

Fractional

Socket Size in.	Model Number	Dimensions in. (mm)						Preset Pressure psi (bar)
		A	D	E	F	L	Tx	
1/4	SS-SWUC-4	1.5 (38)	0.28 (7.1)	0.19 (4.8)	1/2"	0.75 (19.0)	0.43 (11.00)	10700 (737)
3/8	SS-SWUC-6	2.0 (51)	0.31 (7.9)	0.28 (7.1)	5/8"	1.00 (25.5)	0.38 (9.65)	8100 (558)
1/2	SS-SWUC-8	2.24 (57)	0.38 (9.7)	0.41 (10.4)	13/16"	1.12 (28.5)	0.50 (12.80)	6600 (454)

Ordering Information

EXAMPLE: SL - TWMC - 6 - NT4

Materials
SL-316L
SS-316

Series Number	
TWMC	Tube Weld Male Connector
TWFC	Tube Weld Female Connector
TWRU	Tube Weld Reducer Union
TWUE	Tube Weld Union Elbow
TWUT	Tube Weld Union Tee
TWRT	Tube Weld Reducer Tee
TWUC	Tube Weld Union Cross
BWU	Butt Weld Union
BWRU	Butt Weld Reducer Union
BWUE	Butt Weld Union Elbow
BWUT	Butt Weld Union Tee
BWRT	Butt Weld Reducer Tee
BWUC	Butt Weld Union Cross
MRU	Micro Reducer Union
MUE	Micro Union Elbow
MRE	Micro Reducer Elbow
MUT	Micro Union Tee
MRT	Micro Reducer Tee
MUCs	Micro Union Cross
SWMC	Socket Weld Male Connector
SWFC	Socket Weld Female Connector
SWU	Socket Weld Union
SWME	Socket Weld Male Elbow
SWFE	Socket Weld Female Elbow
SWUE	Socket Weld Union Elbow
SWUT	Socket Weld Union Tee
SWUC	Socket Weld Union Cross

Inlet & Outlet Connections			
Types		Sizes	
NT	Male NPT	2	1/8"
		4	1/4"
FNT	Female NPT	6	3/8"
		8	1/2"
		10	5/8"
		12	3/4"
		14	7/8"
		16	1"
		6 M	6 mm
		8 M	8 mm
10 M	10 mm		
12 M	12 mm		
18 M	18 mm		

RELATED CATALOGS

GENTEC® Related Catalogs

Solutions for Life



Gas Control Systems Solutions Overview

- Manifold Systems
- Control Panels
- HP/UHP Regulators
- Pressure Gauges
- Valves & Fittings



Specialty Manifold Systems

- Chrome-plated Brass Specialty Gas Control Panels
- Stainless Steel Specialty Gas Control Panels
- Specialty Gas Manifolds
- Terminal Gas Control Panel
- Other Control Systems
- Accessories



Specialty Gas Regulators & Gauges

- General Purpose Forged Brass Regulators
- High Purity Brass Barstock Regulators
- High Purity Stainless Steel Barstock Regulators
- Accessories



Ultra High Purity

- UHP Regulators
- UHP Diaphragm alves
- UHP Gauges
- UHP Fittings
- Vacuum Generators



Valves

- Needle Valves
- Ball Valves
- Diaphragm Valves
- Cylinder Valves
- Metering Valves
- Gauge Valves
- Check Valves

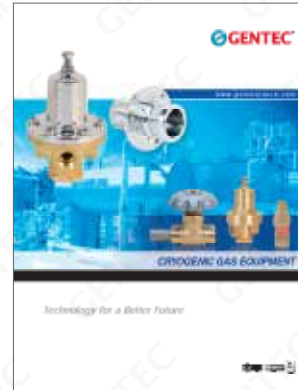

Cryogenic Gas Equipment

- Cryogenic Relief Valves
- Cryogenic Shut-Off Valves
- Regulators
- Check Valves & Burst-Disc
- LNG Nozzle/Quick Disconnect, Receptacle
- Excess Flow Valves
- Pressure Gauges



Tube Fittings

- GENLOK to male NPT thread
- GENLOK to male NPT thread elbow
- Tube to male NPT thread
- GENLOK to female NPT thread
- GENLOK to female NPT thread elbow
- Tube to female NPT thread



Pipe Fittings

- Hex Nipple
- Hex Reducing Nipple
- Coupling
- Reducing Bushing
- Male Elbow
- Street Elbow

Please contact us for any questions about catalogs.

- Requesting Catalogs
- Register an account to view / download pdf catalogs. (Online Register)

To view our full line of Specialty Gas Products please visit us online at www.gentec.com



GENSTAR TECHNOLOGIES COMPANY INC.

4525 Edison Ave, Chino, CA 91710

Tel: 909.606.2726

Fax: 909.606.6485

www.gentec.com

